

FORM No 1.

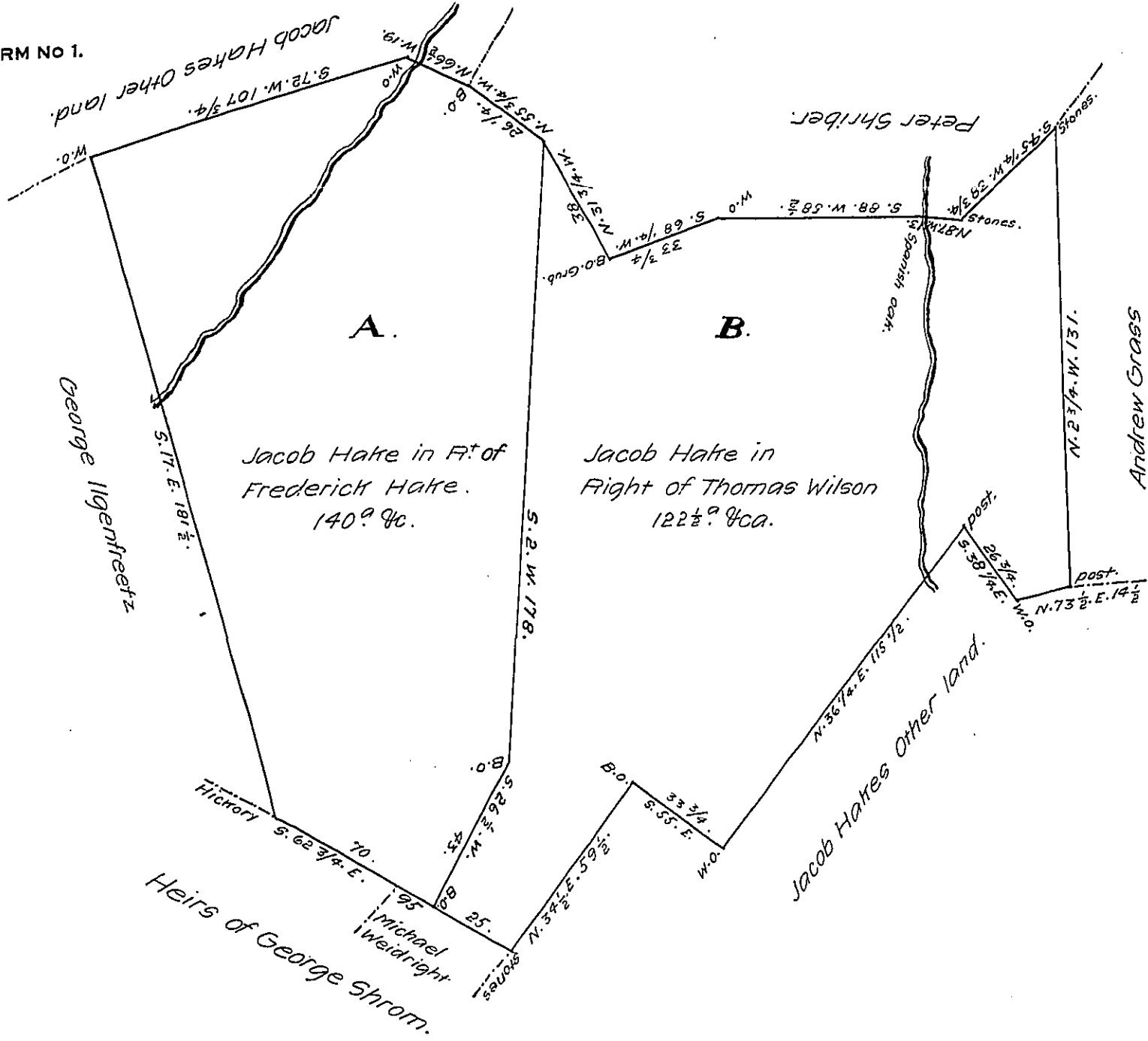

A Draught of Two Tracts of land Situate in Manchester Township in the County of York Containing Together Two Hundred and Sixty Two & a half Acres and Allowance Surveyed the 10th April 1788. The Piece Marked with the letter **B** in Pursuance of a Warrant to Thomas Wilson Dated the 6th day of March 1749 Containing one Hundred and Twenty Two and a half Acres & Allowance &c. The Piece Marked with the letter **A** in Pursuance of a Warrant to Frederick Hake Dated the 14th day of March 1767. Containing one Hundred & forty Acres & Allowance .

N.B. The above was one thought to be within the line of the Manor of Springettsbury, but on Examination found to be at least Tw- Miles North of the Manor line.

John Forsyth. D.S.

John Lukens Esq:
Surveyor General.

IN TESTIMONY that the above is a copy of the original remaining on file in the Department of Internal Affairs of Pennsylvania, made conformably to an Act of Assembly approved the 16th day of February, 1833, I have hereunto set my Hand and caused the Seal of said Department to be affixed at Harrisburg, this twenty sixth day of April 1907.

Loac R. Power
Secretary of Internal Affairs.